

MOT. D 2066

D 2066

MAN –

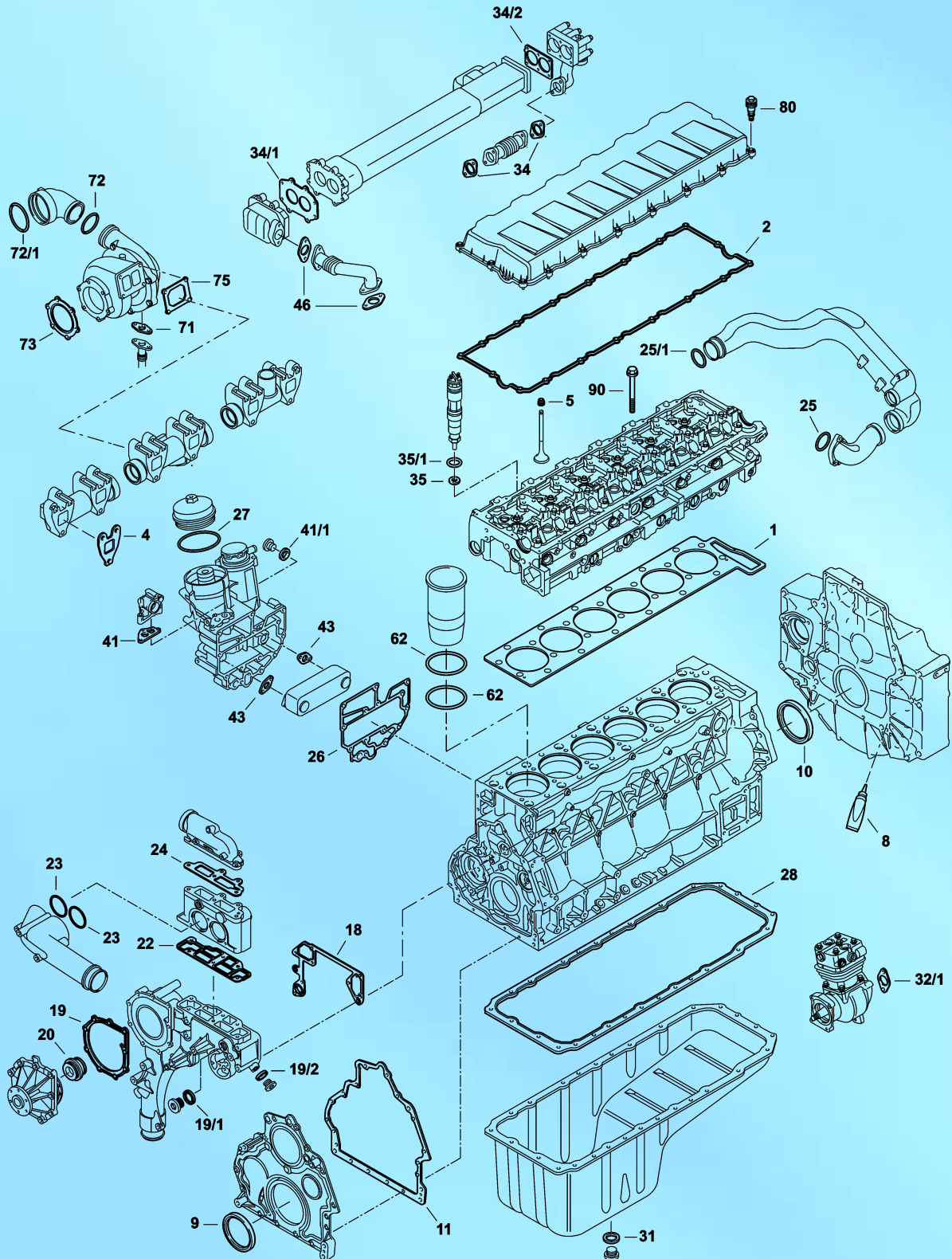

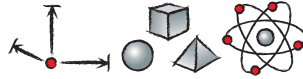

S		198.610	1x	51.00900-6680	-	D2066 LF01-04/6/7/11-20/21-39
ES ⊕		195.080	1x	51.00900-6681	-	-
ZKHS		136.890	1x	-	-	LF LOH
ZKS		124.790	1x	-	-	-
1		021.261	1x	51.03901-0387	-	-
2		141.520	1x	51.03905-0177	-	-
4		008.762	6x	51.08901-0170	-	-
5		814.882	24x	51.04902-0033	9x12/15,4x11 FPM PR	-
8		610.020	1x	04.10394-9272	Dirko grau 310 ml Dirko grey 310 ml Dirko gris 310 ml Dirko grigio 310 ml Dirko серый 310 мл	-
9		158.510	1x	51.01510-0273	100x130x12	-
10		766.828	1x	51.01510-0206	120x140x13	-
11		021.430	1x	51.01905-0091	-	-
18		019.690	1x	51.06903-0061	-	-
19		021.250	1x	51.06901-0192	-	-
19/1		153.280	1x	06.56631-0111	24,7x32x2 St/FPM	-
19/2		153.270	1x	06.56631-0106	14,7x22x1,5 St/FPM	-
20		a.A.	1x	51.06520-0085	-	-
22		021.410	1x	51.06904-0042	-	-
23		762.610	2x	06.56341-2122	60x4 NBR RD	-
24		021.380	1x	51.06904-0039	-	-
25		a.A.	1x	06.56936-2423	60x3 FPM RD	-
25/1		a.A.	1x	06.56939-0071	56x4 EPDM RD	-
26		021.270	1x	51.05901-0144	-	LF LOH
26		-	1x	51.05901-0137	-	LUH
27		a.A.	1x	51.96501-0204	-	-
28		492.520	1x	51.05904-0204	EWP	-
28		357.570	1x	51.05904-0212	Elastomer Rubber Caoutchouc Гума Elastomero Эластомер	-
31		153.260	1x	06.56631-0110	22,7x30x2 St/FPM	-
32/1		a.A.	1x	51.96601-0548	-	-
34		021.370	2x	51.08901-0174	-	-
34/1		058.360	1x	51.08901-0195	-	-
34/2		008.790	1x	51.08901-0172	-	-
35		293.140	6x	51.98701-0118	7,7x15x1,5	-
35/1		a.A.	6x	51.96501-0502	-	-
41		-	1x	51.05901-0135	-	-
41/1		804.360	1x	06.56631-0109	1807x26x1,5 FE/FPM	-
43		759.296	2x	06.56254-2203	-	-
46		747.050	2x	51.08901-0120	-	-
62		152.230	12x	51.96501-0534	-	-
71		303.421	1x	51.96601-0576	-	-
72		060.150	1x	06.56936-2479	-	-
72/1		-	1x	06.56936-3004	-	-
73		155.570	1x	51.08901-0209	-	-
75		139.090	1x	51.08901-0182	-	-
80		006.420	18x	51.96210-0080	-	11 Nm