

MOT. D 2866 LF 23 | 24 | 25 | 26 | 27 | 28 | 30 | 31 | 32 | 34 | 35 | 36 | 37 | 41

MOT. D 2876 LF 03-11 | 14 | 17 | 20

MOT. D 2876 LOH 02 | 03 | 05

D 2866 4V
D 2876 4V

MAN –



Das Original

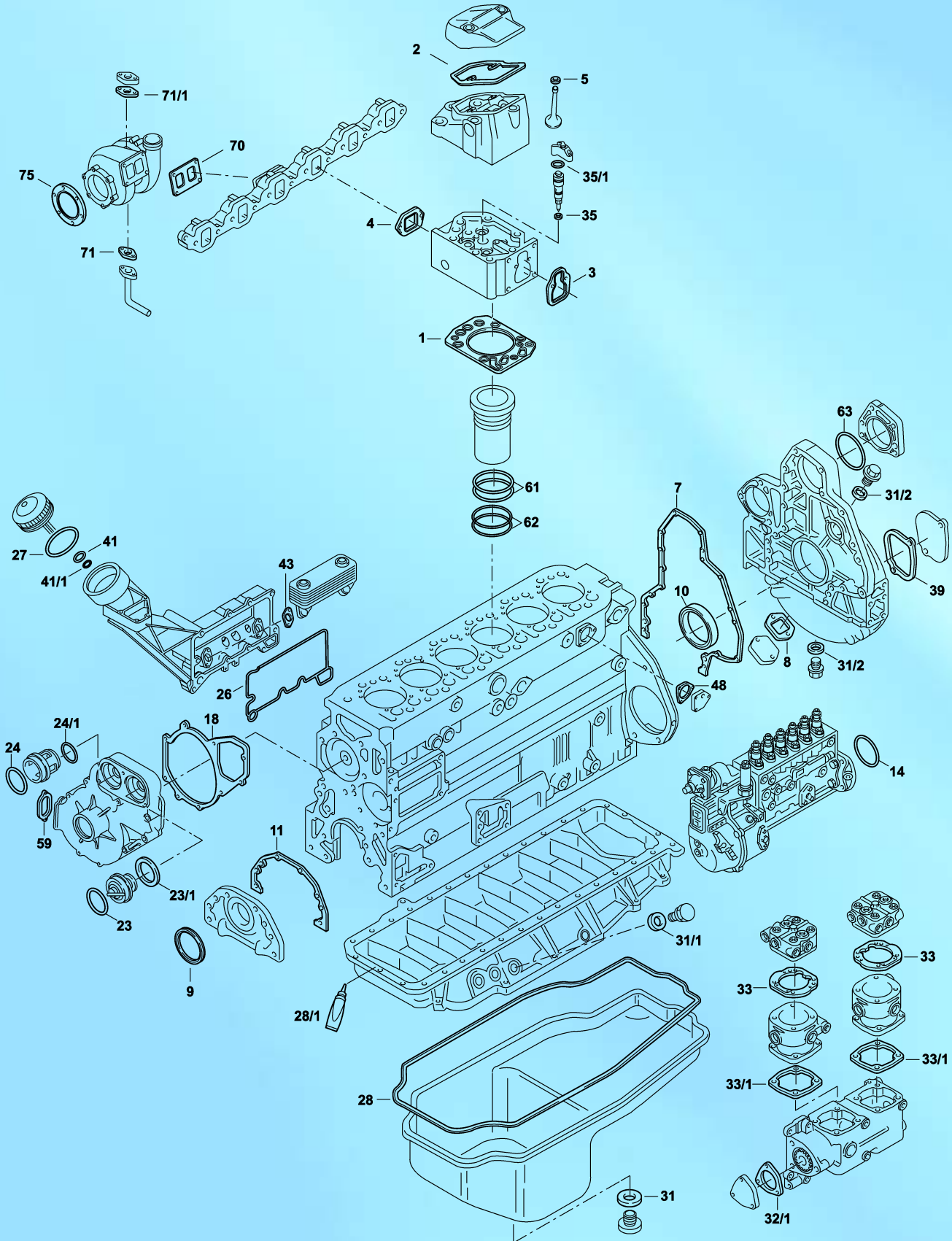

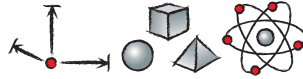

S ⊕ *	061.690	1x	51.00900-6635	-	-
ES ⊕	296.770	6x	51.00900-6630	-	ohne Zylinderkopfhaubendichtung without valve cover gasket sans joint de couvercle de culasse sin junta de tapa de culata senza guarnizione coperchio punteria без прокладки крышки ГБЦ
CS *	353.551	1x	-	-	-
ZLBS	216.930	6x	-	-	incl. 51.96501-0417 (12x)
ZLBS	216.940	6x	-	-	incl. 51.96501-0540 (6x)
VAS	830.941	2x	-	-	-
ZKS	015.920	6x	-	-	-
1	829.722	6x	51.03901-0338	ME-Insert	-
2	123.410	5x	51.03905-0157	ME	ohne Kabeldurchführung without cable channel sans passe-câble sin pasacables senza passaggio cavi без кабельного канала
2	123.420	1x	51.03905-0161	ME	mit Kabeldurchführung with cable channel avec passe-câble con pasacables senza passaggio cavi с кабельным каналом
3	360.751	6x	51.08902-0194	-	-
4	762.940	6x	51.08901-0152	-	-
5	814.882	24x	51.04902-0033	9x12/15,4x11 FPM PR	-
7	829.595	1x	51.01903-0252	-	-
8	705.705	1x	04.10394-9292	Dirko rot 70 ml Dirko red 70 ml Dirko rouge 70 ml Dirko rojo 70 ml Dirko rosso 70 ml Dirko красный 70 мл	-
9	766.852	1x	51.01510-0197	105x130x12 RD PTFE / ACM	-
9/1	828.645	1x	51.01501-6013	105x130x12 RD PTFE / ACM	incl. Laufring 51.02130-0012 incl. race 51.02130-0012 bague de roulement incl. 51.02130-0012 incl. anillo de rodadura 51.02130-0012 incl. anello di scorrimento 51.02130-0012 вкл. вращающиеся кольца 51.02130-0012
10	766.828	1x	51.01510-0206	120x140x13 LD PTFE / ACM	-
10/1	828.637	1x	51.01501-6012	120x140x13 LD PTFE / ACM	incl. Laufring 51.02130-0013 incl. race 51.02130-0013 bague de roulement incl. 51.02130-0013 incl. anillo de rodadura 51.02130-0013 incl. anello di scorrimento 51.02130-0013 вкл. вращающиеся кольца 51.02130-0013
11	834.556	1x	51.01903-0251	-	-
14	106.607	1x	51.96501-0346	138x145x3,5 FPM RD	-
18	756.882	1x	51.06901-0147	-	-
23	088.872	1x	06.56341-2122	60x68x4 NBR RD	-
23/1	977.447	1x	51.06901-0108	-	-
24	088.872	1x	06.56341-2122	60x68x4 NBR RD	-
24/1	095.842	1x	51.96501-0337	36,5x43,5x3,5 NBR RD	-
26	803.820	1x	51.05901-0119	EWP	-
26	012.300	1x	51.05901-0122	Elastomer Rubber Caoutchouc Гома Elastomero Эластомер	-
27	147.760	2x	06.56933-6408	-	-
28	845.541	1x	51.05904-0198	Elastomer Rubber Caoutchouc Гома Elastomero Эластомер	-

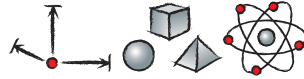

28/1	610.020	1x	04.10394-9272	Dirko grau 310 ml Dirko grey 310 ml Dirko gris 310 ml Dirko grigio 310 ml Dirko серый 310 мл	-
31	153.260	1x	06.56631-0110	ME	-
31/1	122.904	1x	06.56190-0713	18x24 Cu A	-
31/2	115.100	2x	06.56190-0706	14x20 Cu A	-
32/1	286.347	1x	51.08902-0151	-	-
33	775.790	2x	51.54901-0027	-	-
33/1	756.220	1x	51.54901-0028	-	-
35	296.660	6x	51.98701-0111	7,3x15x1 Cu A	-
35/1	296.520	6x	06.56936-6409	24,6x29,6x2,5 FPM RD	-
39	765.880	1x	51.01903-0235	-	-
41	a.A.	2x	06.56939-0027	-	-
43	759.296	2x	51.96601-0416	-	-
59	768.391	1x	51.06901-0111	-	-
61	825.778	12x	51.96501-0417	138x142,2x2,1 FPM RD	-
61	131.020	6x	51.96501-0540	FPM PR	-
62	518.131	12x	51.96501-0412	144x152x4 FPM RD	-
63	244.848	1x	51.96501-0324	126x133x3 FPM RD	-
70	321.541	1x	51.08901-0150	-	-
71	a.A.	1x	51.96601-0575	-	-
71/1	803.970	1x	51.96601-0577	-	-
75	830.748	1x	51.15901-0012	-	-