

MOT. D 2876 LF 12 | 13
MOT. D 2876 LOH 20

D 2876 4V

MAN –



Das Original

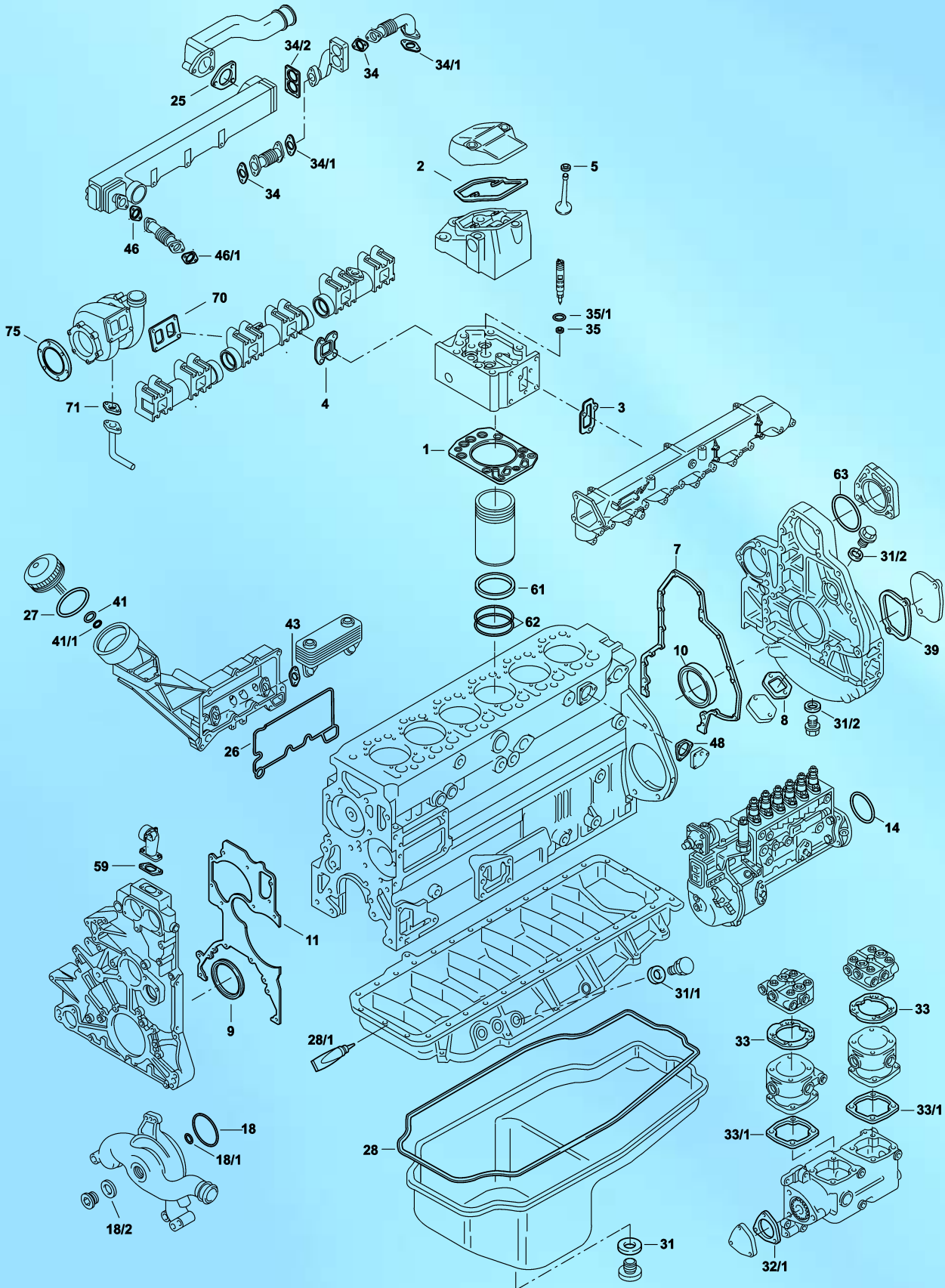

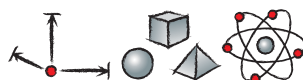

S ⊕ *	124.960	1x	51.00900-6652	-	-
ES ⊕	009.981	6x	51.00900-6653	-	-
ZLBS	216.930	6x	-	-	incl. 51.96501-0417 (12x)
ZLBS	216.940	6x	-	-	incl. 51.96501-0540 (6x)
VAS	830.941	2x	-	-	-
1	099.980	6x	51.03901-0382	ME-Insert	-
2	100.012	6x	51.03905-0180	ME	mit Kabeldurchführung with cable channel avec passe-câble con pasacables senza passaggio cavi с кабельным каналом
3	100.040	6x	51.08902-0202	-	-
4	100.020	6x	51.08901-0155	-	-
5	814.882	12x	51.04902-0033	9x12/15,4x11 FPM PR	-
7	829.595	1x	51.01903-0252	-	-
8	705.705	1x	04.10394-9292	Dirko rot 70 ml Dirko red 70 ml Dirko rouge 70 ml Dirko rojo 70 ml Dirko rosso 70 ml Dirko красный 70 мл	-
9	766.852	1x	51.01510-0197	105x130x12 RD PTFE / ACM	-
9/1	828.645	1x	51.01501-6013	105x130x12 RD PTFE / ACM	incl. Laufring 51.02130-0012 incl. race 51.02130-0012 bague de roulement incl. 51.02130-0012 incl. anillo de rodadura 51.02130-0012 incl. anello di scorrimento 51.02130-0012 вкл. вращающиеся кольца 51.02130-0012
10	766.828	1x	51.01510-0206	120x140x13 LD PTFE / ACM	-
10/1	828.637	1x	51.01501-6012	120x140x13 LD PTFE / ACM	incl. Laufring 51.02130-0013 incl. race 51.02130-0013 bague de roulement incl. 51.02130-0013 incl. anillo de rodadura 51.02130-0013 incl. anello di scorrimento 51.02130-0013 вкл. вращающиеся кольца 51.02130-0013
11	746.791	1x	51.01901-0129	-	-
14	106.607	1x	51.96501-0346	138x145x3,5 FPM RD	-
18	a.A.	1x	06.56939-0067	75,87x2,62 EPDM 70 Shore A	-
18/1	a.A.	1x	06.56939-0046	23,52x1,78 EPDM 70 Shore A	-
18/2	031.151	1x	06.56200-0707	42x49x2 Cu A	-
25	924.971	1x	51.06901-0157	-	-
26	012.300	1x	51.05901-0122	-	-
27	a.A.	1x	51.96501-0487	-	-
28	845.541	1x	51.05904-0198	Elastomer Rubber Caoutchouc Goma Elastomero Эластомер	-
28/1	705.705	1x	04.10394-9292	Dirko rot 70 ml Dirko red 70 ml Dirko rouge 70 ml Dirko rojo 70 ml Dirko rosso 70 ml Dirko красный 70 мл	-
31	153.260	1x	06.56631-0110	22,7x30x2 St/FPM	-
31/1	122.904	1x	06.56190-0713	18x24x1,5 Cu A DIN 7603	-
31/2	115.100	2x	06.56190-0706	14x20x1,5 Cu A DIN 7603	-
32/1	286.347	1x	51.08902-0151	-	-
33	775.790	2x	51.54901-0027	-	-
33/1	756.220	2x	51.54901-0028	-	-
34	747.010	2x	51.08901-0117	-	-
34/1	a.A.	2x	51.08901-0121	-	-
34/2	761.051	1x	51.08901-0115	EWP	-
34/2	761.061	1x	51.08901-0114	MLS	LF
34/2	100.080	1x	51.08901-0166	MLS	LUH 23-52
35	293.140	6x	51.98701-0118	7,6x15x1,5 Cu A	-
35/1	a.A.	6x	06.56333-2256	24x30x3 FPM 70 Shore A	-

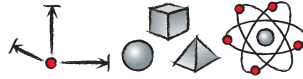

39	765.880	1x	51.01903-0235	-	-
41	a.A.	1x	51.96501-0486	12x16x2 ACM RD	-
41/1	a.A.	1x	51.96501-0485	8x12x2 ACM RD	-
43	759.296	2x	51.96601-0416	-	-
46	a.A.	1x	51.08901-0124	-	-
46/1	747.050	1x	51.08901-0120	-	-
48	924.971	1x	51.06901-0157	-	-
59	768.391	1x	51.06901-0111	-	-
61	825.778	12x	51.96501-0417	138x142,2x2,1 FPM RD	-
61	131.020	6x	51.96501-0540	FPM PR	-
61	131.020	6x	51.96501-0540	FPM PR	-
62	518.131	12x	51.96501-0412	144x152x4 FPM RD	-
63	244.848	1x	51.96501-0324	126x133x3 FPM RD	-
70	139.090	1x	51.08901-0182	-	-
71	a.A.	1x	51.96601-0575	-	-
75	830.748	1x	51.15901-0012	-	-