

MOT. 366.941-949 | 951-958 | 960 | 962 | 963 | 965-971 | 973-981 | 983 | 984
MOT. 366.988 | 990 | 992-997 | 999
MOT. 356.940 | 941 | 943-959 | 977-980 | 983-996 | 999
MOT. 357.901-910 | 915-922 | 924-927 | 929-933 | 936-938 | 940-949 | 961-963

OM 366 A | LA

Mercedes-Benz –



Das Original

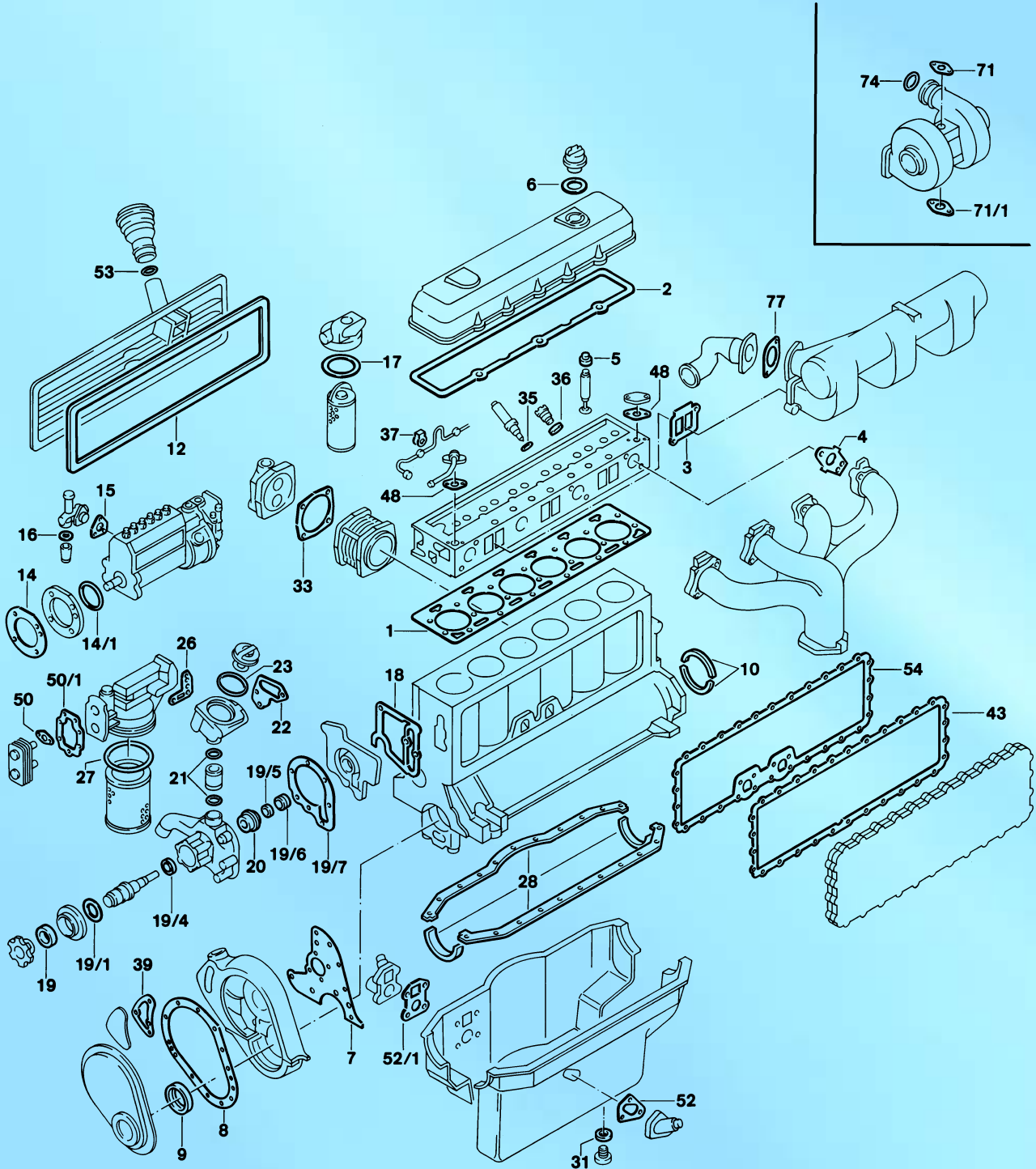

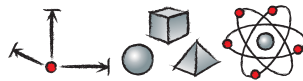

S ⊕ *	826.750	1x	-	-	Mot. 366.941-943/945/946/951-953/ 957/962/965/967-971/973/979-981/ 983/988/990/993/995-997 Mot. 356.940/943/944/946/948/951/ 953/984/985/986/987/990/992 Mot. 357.900-904/908/915-919/963
S ⊕ *	826.783	1x	-	-	Mot. 366.944/966/974/976/978/992/ 994 Mot. 356.941/945/947/952/959/994/ 995 Mot. 357.906/907/909/910
ES	813.877	1x	366 010 61 20	-	Mot. 366.941-949/951-958/960/962/ 963/965-971/973-981/983/984/988/ 990/992-997/999 Mot. 356.940/941/943-959/984-987/ 990/992/994/995 Mot. 357.901-910/915-919/963
ES	890.456	1x	366 010 71 20	-	Mot. 366.999 Mot. 356.977-980/983/993/996/999 Mot. 357.920-922/924-927/929-933/ 936-938/940-949/961/962
CS *	817.481	1x	366 010 44 08	-	-
OKS	828.181	1x	366 180 37 65	-	-
ZKS	820.075	1x	-	-	-
1	760.678	1x	366 010 06 20	-	-
2	768.820	1x	366 016 03 21	-	-
3	768.929	3x	366 141 07 80	-	Mot. 366.941-949/951-958/960/962/ 963/965-971/973-981/983/984/988/ 990/992-996/999 Mot. 356.940/941/943-959/984-987/ 990/992/994/995 Mot. 357.901-910/915-919/963
3	824.829	3x	366 141 10 80	-	Mot. 366.999 Mot. 356.977-980/983/993/996/999 Mot. 357.920-922/924-927/929-933/ 936-938/940-949/961/962
4	461.873	4x	366 142 08 80	-	-
5	577.898	6x	366 053 00 58	-	E
5	577.901	6x	366 053 01 58	-	A
6	827.428	1x	102 018 03 80	38,5x59x2,3 HNBR A	-
7	977.160	1x	366 015 01 80	-	-
8	768.804	1x	366 015 00 20	-	-
9	553.272	1x	014 997 16 47	AW/BS RD FPM 65x90x12	-
10	837.549	2x	001 997 41 41	-	-
12	351.939	1x	366 015 00 60	-	-
14	112.802	1x	352 076 02 80	-	-> Mot. 043295
14	a.A.	1x	011 997 16 48	119x125x3 NBR RD	Mot. 043296 ->
14/1	a.A.	1x	014 997 61 48	78x84x3 ACM RD	-
15	a.A.	1x	001 074 22 80	-	-
16	716.200	1x	000 997 00 40	28x36x2 NBR A	-
17	731.269	1x	000 477 35 80	-	-
18	768.033	1x	366 201 04 80	-	-
19	344.400	1x	003 997 51 46 005 997 00 47	A NBR 42x56x7	-
19/1	a.A.	1x	005 997 11 45	62x68x3 NBR RD	-
19/4	054.003	1x	002 997 84 46 005 997 01 47	A NBR 17x35x7	-
19/5	a.A.	1x	000 201 04 63	-	-
19/6	190.608	1x	000 201 01 97	-	-

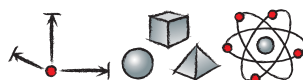

19/7	768.961	1x	364 201 02 80	-	-
20	577.804	1x	000 201 92 19	-	-
21	a.A.	2x	011 997 70 48	-	-
22	768.979	1x	366 203 02 80	-	-
23	088.872	1x	020 997 11 48	-	-
26	a.A.	1x	364 184 02 80	-	-
27	780.103	1x	008 997 70 45	134x142x4 NBR RD	-> Mot. 923826 (1988)
27	305.308	1x	006 997 25 48	-	Mot. 923827 (1990) -> Mot. 286114 (1993)
27	-	1x	019 997 36 48	-	Mot. 286115 -> (1993)
28	284.734	1x	366 010 06 80	-	Mot. 366.941-943/945/946/951-953/ 957/962/965/967-971/973/979-981/ 983/988/990/993/995-997/999 Mot. 356.940/943/944/946/948/951/ 953/977/979/983/984/985/986/987/ 989-992/993/996/999 Mot. 357.901-905/908/915-922/ 925-927/929-933/936-938/940-942/ 946-949/961/962/963
28	-	1x	366 010 06 80	einteilig single-piece mono piéce monopieza in un pezzo unico из одной части	Mot. 366.941-943/945/946/951-953/ 957/962/965/967-971/973/979-981/ 983/988/990/993/995-997/999 Mot. 356.940/943/944/946/948/951/ 953/977/979/983/984/985/986/987/ 989-992/993/996/999 Mot. 357.901-905/908/915-922/ 925-927/929-933/936-938/940-942/ 946-949/961/962/963
28	893.110	1x	366 010 07 80	-	Mot. 366.944/966/974/976/978/992/ 994/995 Mot. 356.941/945/947/952/959/994/ 995 Mot. 357.906/907/909/910/943/944
28	088.854	1x	352 010 04 80	-	Mot. 366.947-949/954/955/956/958/ 963/977 Mot. 356.950/954-957/980 Mot. 357.924/945
31	031.046	1x	007603 026109	26x34x2 DIN 7603 CU A	-
33	768.863	1x	366 131 02 80	0,65 mm (94 mm Ø Cyl.)	-
33	768.871	1x	366 131 01 80	0,9 mm (94 mm Ø Cyl.)	-
35	a.A.	6x	388 017 01 60	1 mm	-
35	067.989	6x	346 017 02 60	1,5 mm	-
36	776.262	6x	016 997 82 48	30,8x38,2x3,7 FPM RD	-
37	175.811	6x	352 078 00 80	-	-
39	a.A.	1x	352 015 03 80	-	-
43	775.657	1x	366 188 02 80	-	-
48	768.988	1x	366 203 03 80	-	-
50	777.846	2x	364 184 03 80	-	-> Mot. 923826
50/1	-	1x	355 188 01 80	-	-> Mot. 923826
52	-	2x	366 018 02 80	-	-
52/1	-	2x	366 018 04 80	-	-
53	219.711	1x	000 997 53 48	-	-> Mot. 234537 (1992)
54	829.773	1x	366 188 05 80	-	-
71	756.874	1x	442 187 01 80	-	-
71/1	756.866	1x	442 187 00 80	-	-
74	892.653	1x	012 997 37 48	45x53x4 VMQ RD	-
77	a.A.	1x	366 098 15 80	-	-