

OM 447 H I H A I H L A

Mercedes-Benz –

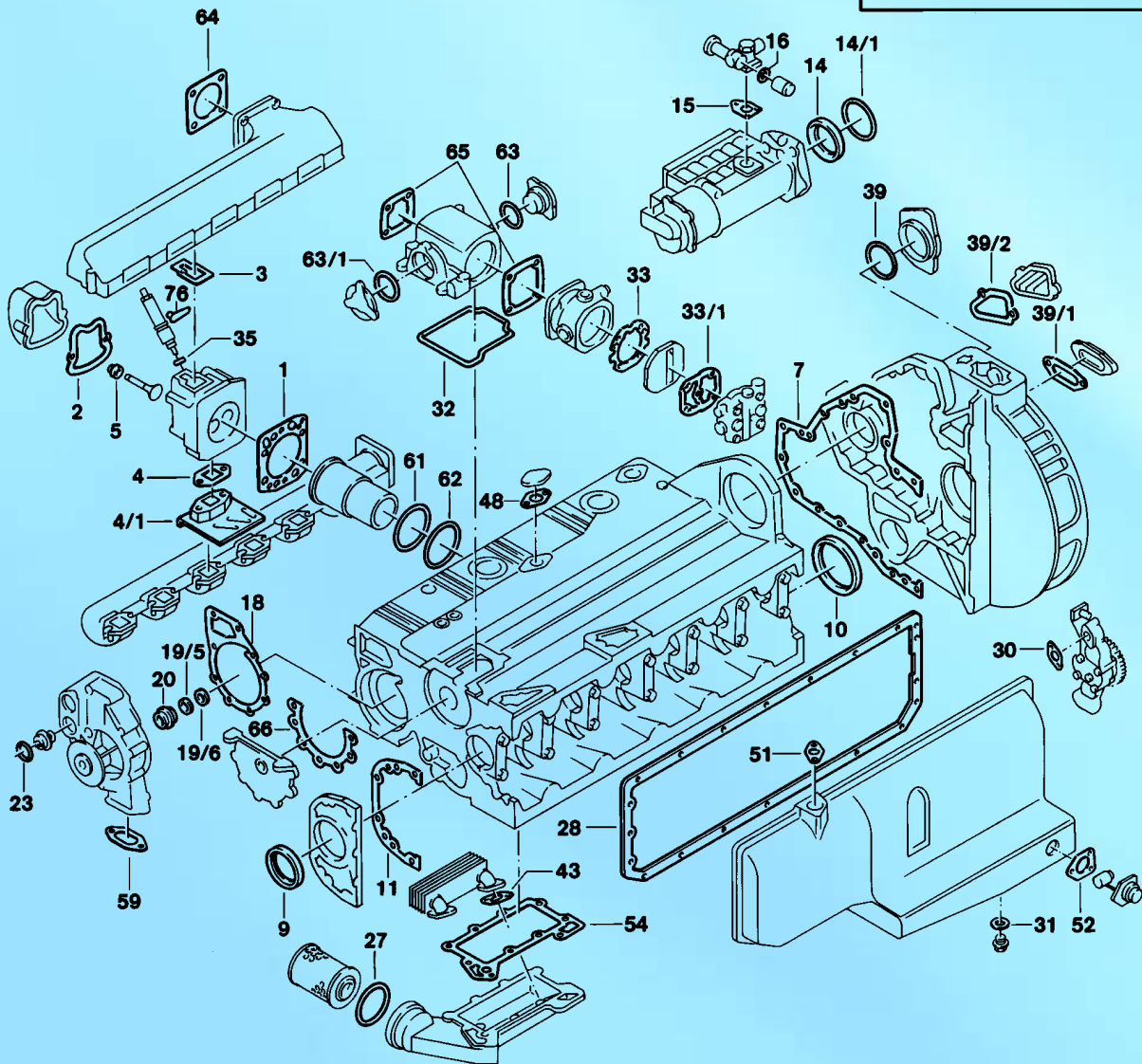

Das Original

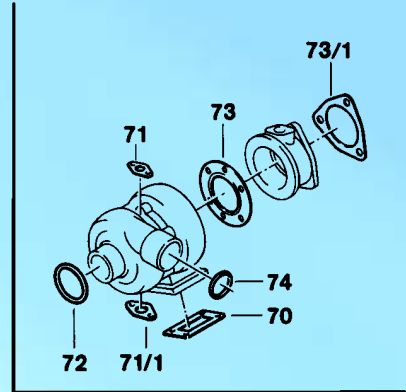

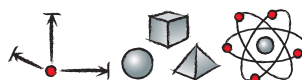

S ⊕ *	914.983	1x	-	-	-
ES	894.303	6x	447 010 07 20	-	Mot. 447.905-908/910-916/925/ 950-956/958/968/970-972/980-983/ 985/987/988/990-994
ES	812.544	6x	444 010 01 20	-	Mot. 447.957/959/984/986 incl. 896.510
ES	812.545	6x	444 010 01 20	-	Mot. 447.957/959/984/986 incl. 412.180
CS *	812.625	1x	427 010 00 05	-	-
ZLBS	827.541	6x	-	-	-> Mot. 039041
ZLBS	827.568	6x	-	-	Mot. 039042 -> incl. Tombak
WPS	812.617	1x	422 200 09 01	-	-
ZKS	820.091	6x	-	-	-
1	748.080	6x	422 016 06 20	143,5 Ø, 1,23 mm	-
1	748.110	6x	422 016 07 20	143,5 Ø, 1,33 mm	Reparaturstufe repair size cote de réparation nivel de reparaci3n livello di riparazione стадия ремонта
1	896.510	6x	442 016 03 20	143,5 Ø, 1,25 mm	-
1	412.180	6x	442 016 04 20	143,5 Ø, 1,25 mm	-
2	977.438	6x	442 016 06 21	-	-
3	896.365	6x	442 141 17 80	-	-
4	225.126	6x	403 142 03 80	-	Mot. 447.957/959/984/986
4	-	1x	447 142 02 80	-	Mot. 447.947-949/960/973-979/996/ 998/999
4	-	1x	447 142 03 80	-	Mot. 447.947-949/960/973-979/996/ 998/999
4/1	325.740	6x	407 142 01 80	-	Mot. 447.905-908/910-916/925/ 950-956/958/968/970-972/980-983/ 985/987/988/990-994
5	562.297	12x	422 053 01 96	12x15,7/20x15 FPM	-
7	819.183	1x	447 015 00 80	-	-
9	524.973	1x	014 997 46 47	AW/BS RD FPM 105x130x12	-
10	562.920	1x	013 997 14 47	AW/BS LD FPM 120x140x13	-
11	756.769	1x	442 011 00 80	-	-
14	-	1x	013 997 90 47	-	-
14/1	203.157	1x	009 997 86 45	138x145x3,5 NBR RD	-
15	a.A.	1x	001 074 22 80	-	-
16	716.200	1x	000 997 00 40	28x36x2 NBR A	-
18	756.882	1x	442 201 00 80	-	-
20	577.804	1x	000 201 92 19	-	-
23	495.980	2x	024 997 28 48	-	-
27	780.103	1x	008 997 70 45	134x142x4 NBR RD	-
28	768.368	1x	447 014 00 22	-	mit Siebdruck with screen print avec sérigraphie con serigrafia con serigrafia с тиснением
28	921.084	1x	447 014 00 22	-	ohne Siebdruck without screen print sans sérigraphie sin serigrafia senza serigrafia без тиснения
30	759.300	2x	917003 036003	-	-
31	031.046	2x	007603 026109	26x34x2 CU A	-
32	463.523	1x	407 131 05 80	-	-> Mot. 048474
33	775.790	1x	442 131 09 80	-	-> Mot. 001443
33	773.204	1x	442 131 06 80	-	Mot. 001444 -> 066464
33/1	-	1x	001 131 73 80	-	-> Mot. 001443
33/1	137.452	1x	442 131 29 80	-	Mot. 001444 -> 066464
33/1	-	1x	442 131 26 80	-	Mot. 066465 ->
35	106.909	6x	346 017 01 60	1 mm	-
35	067.989	6x	346 017 02 60	1,5 mm	-
39/2	a.A.	1x	407 015 03 80	-	-
43	759.296	2x	917003 026003	-	-

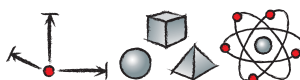

48	896.446	1x	355 997 01 49	-	-
51	896.446	1x	355 997 01 49	-	-
52	768.413	2x	447 014 00 80	-	-
54	765.734	1x	442 188 05 80	-	-
59	768.391	1x	442 201 04 80	-	-
61	-	12x	025 997 84 48	140x143,8x1,9 FPM RD	-> Mot. 039041
61	-	6x	025 997 84 48	140x143,8x1,9 FPM RD	Mot. 39042 ->
61/1	703.214	6x	442 011 00 59	Metal 0,15 mm	Tombak Mot. 39042 ->
61/1	863.020	6x	-	Metal 0,25 mm	Tombak Mot. 39042 ->
61/1	896.455	6x	442 011 02 59	Metal 0,50 mm	Tombak Mot. 39042 ->
62	001.880	12x	025 997 85 48	144x151,6x3,8 FPM RD	-
63	a.A.	-	014 997 61 48	78x84x3 ACM RD	-
63/1	a.A.	1x	010 997 19 45	87x93x3 ACM RD	-
63/1	-	1x	447 131 02 80	-	-
64	-	-	-	-	-
65	422.400	2x	442 131 27 80	-	-
66	924.644	1x	447 011 01 80	-	-
70	104.132	1x	355 142 01 80	-	-
71	768.384	1x	447 187 01 80	-	-
71/1	768.375	1x	447 187 00 80	-	-
72	a.A.	1x	003 997 34 48	88x98x5 NBR RD	-
73	-	-	-	-	-
73/1	-	-	-	-	-
74	345.351	2x	021 997 53 48	60x76x8 VMQ RD	-