

MOT. 457.914-920 | 922-929 | 931 | 932 | 936 | 937 | 939 | 940 | 943-947 | 948 | 949 | 955-958 | 960 | 962
MOT. 458.960 | 970 | 980
MOT. 457.933-935 | 941 | 942 | 950 | 952 | 959 | 964-966

OM 457 LA | HLA

Mercedes-Benz –

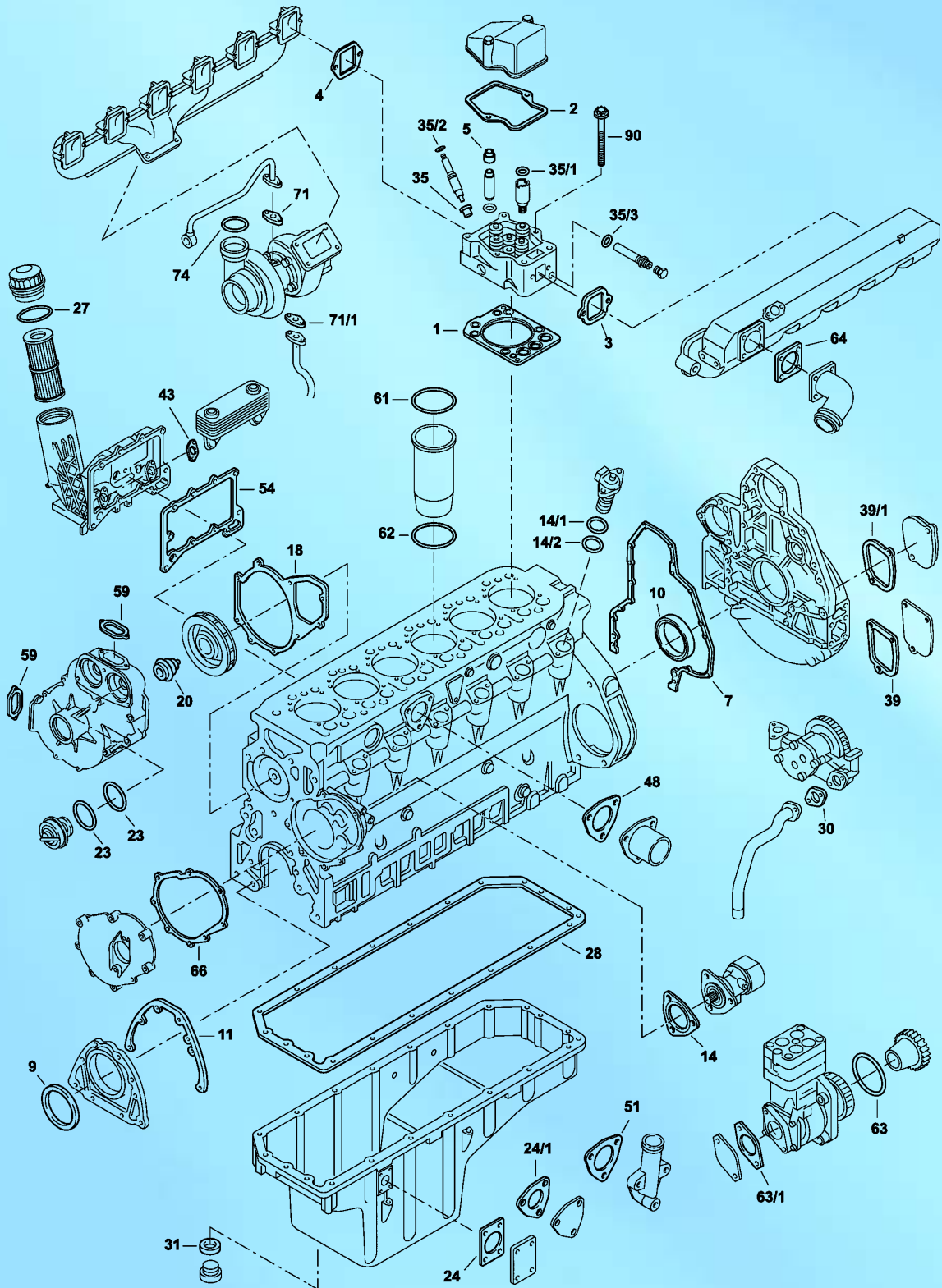

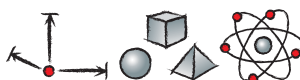

S ⊕ *	136.290	1x	-	-	für Alu-Haube for aluminiumcover pour couvercle en alu para tapa de aluminio per coperchio in alluminio для крышки ГБЦ из алюминия
ES	058.540	6x	457 010 73 20	-	für Alu-Haube for aluminiumcover pour couvercle en alu para tapa de aluminio per coperchio in alluminio для крышки ГБЦ из алюминия
ES	264.715	6x	-	-	für Kunststoffhaube for plastic cover pour couvercle en plastique para tapa de plástico per coperchio in materiale sintetico для крышки ГБЦ из пластмассы
ES	167.780	6x	-	-	Mot. 457.924/925/926/928/929/931 Mot. 458.960/970/980
CS *	018.785	1x	457 010 01 05	-	-
ZLBS	084.121	6x	-	-	incl. Tombak
SZ	066.460	6x	906 017 02 60	-	O-Ringe für Zylinderkopf o-ring set for cylinder head joint torique pour culasse juntas tóricas para culatas o-ring per testata кольца круглого сечения для ГБЦ
ZKS	132.210	6x	-	-	-
1	002.281	6x	457 016 11 20	-	-
1	167.901	6x	457 016 12 20	-	-
2	467.720	6x	457 016 00 21	-	für Alu-Haube for aluminiumcover pour couvercle en alu para tapa de aluminio per coperchio in alluminio для крышки ГБЦ из алюминия
2	001.796	6x	457 016 02 21	-	für Kunststoffhaube for plastic cover pour couvercle en plastique para tapa de plástico per coperchio in materiale sintetico для крышки ГБЦ из пластмассы
3	401.410	6x	457 141 00 80	-	-
4	-	2x	457 142 07 80	-	Mot. 457.933-935/938/941/942/950/ 952/954/959/965/966
4	432.040	6x	541 142 02 80	-	Mot. 457.914-920/923/927/932/936/ 937/939/940/943/945-947/949/955/ 958
4	225.126	6x	403 142 03 80	-	Mot. 457.924/925/926/928/929/931 Mot. 458.960/970/980
5	814.882	24x	000 053 35 58	9x12/15,4x11 FPM PR	-
7	151.860	1x	457 015 01 80	-	-
9	524.973	1x	014 997 46 47	AW/BS RD FPM 105x130x12	-
9	369.901	1x	025 997 39 47	AW RD PTFE/ACM 100x130x11	-
10	562.920	1x	013 997 14 47	AW/BS LD FPM 120x140x13	-
10	354.090	1x	025 997 50 47	ASW LD PTFE/ACM 115x140x12	-
11	690.330	1x	541 011 00 80	EWP 207	-
11	075.912	1x	541 011 01 80	Metaloseal	-
14	a.A.	1x	457 091 01 80	-	-
14/1	152.610	6x	023 997 64 48	47x52x2,5 FPM RD	-
14/2	152.630	6x	023 997 65 48	45x50x2,5 FPM RD	-
18	122.580	1x	457 201 00 80	-	-
20	577.804	1x	000 201 92 19	-	-
23	495.980	2x	024 997 28 48	-	-
24	896.446	1x	355 997 01 49	-	Mot. 457.933-935/938/941/942/950/ 952/954/959/964-966
24	756.784	1x	442 018 00 80	-	Mot. 457.914/919/921/922-926/928/ 929/931/936/939/940/943/944/953/ 961 Mot. 458.960/970
24/1	-	1x	447 014 01 80	-	Mot. 458.960/970/980

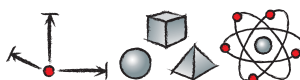

27	-	2x	019 997 36 48	-	Mot. 457.933-935/938/941/942/950/ 952/954/959/964/965/966
27	-	1x	021 997 27 48	-	Mot. 457.919/922/927/928/932/ 937/943/944/947/948/951/960
27	780.103	1x	008 997 70 45	-	Mot. 457.914-916/920/923-926/928/ 929/931/932/936/939/940/944-946/ 949 Mot. 458.960/970/980
28	768.368	1x	447 014 00 22	-	-
28	006.660	1x	457 014 01 22	-	-
30	759.309	1x	917003 036003	-	-
31	133.400	1x	007603 026101	26x32x2 CU A	-
35	124.870	6x	906 017 02 60	7x15,1x1,5 CU PR	-
35/1	074.870	6x	541 997 07 45	25x3,7 FPM RD	-
35/2	000.230	6x	541 997 05 45	20,9x3 FPM RD	-
35/3	761.559	6x	541 997 06 45	11x3 FPM RD	-
39	-	1x	457 015 00 80	-	Mot. 457.914-916/919/920/922-929/ 931-935/938/939/941/942/945/946/ 949/950/952/954/956/958/959/ 964-966 Mot. 458.960/970/980
39/1	a.A.	1x	407 015 03 80	-	Mot. 457.933-938/939/940
43	759.296	2x	917003 026003	-	-
48	a.A.	1x	457 201 01 80	-	-
51	896.446	1x	355 997 01 49	-	Mot. 457.933-935/938/941/942/950/ 952/954/959/964-966
51	756.784	1x	442 018 00 80	-	Mot. 457.914/919/921/922-926/928/ 929/931/936/939/940/943/944/ 953/961 Mot. 458.960/970
54	765.733	1x	442 188 05 80	-	-
54	097.770	1x	457 188 02 80	-	für Ölfilter 457 180 10 10 for oil filter 457 180 10 10 pour filtre à huile 457 180 10 10 para filtro de aceite 457 180 10 10 per filtro olio 457 180 10 10 для масляный фильтр 457 180 10 10
59	811.866	1x	442 201 03 80	-	-
59	768.391	1x	442 201 04 80	-	-
61	490.890	6x	457 011 02 59	Metal 0,15 mm	Tombak
61	257.130	6x	457 011 04 59	Metal 0,3 mm	Tombak
61	257.120	6x	457 011 05 59	Metal 0,5 mm	Tombak
62	084.110	12x	457 997 05 45	144,5 FPM PR	-
63	a.A.	2x	457 997 00 45	84x90x3 ACM RD	-
64	490.591	1x	457 098 00 80	-	-
66	-	1x	457 011 08 80	-	-
71	756.874	1x	442 187 01 80	-	-
71	115.100	1x	007603 014106	14x20x1,5 CU A	-
71/1	756.865	1x	442 187 00 80	-	-
74	268.402	1x	021 997 84 48 027 997 79 48	-	Mot. 457.933-935/942
74	268.372	1x	026 997 38 48	-	Mot. 457.918/936-947/949/952/953/ 956/960/961/964/965 Mot. 458.970/980/990/991
90	-	24x	457 990 02 01	-	-