

MOT. 542.920-926 | 940-948 | 956-958 | 960-966 | 970 | 971  
MOT. 522.940-943 | 950  
MOT. 942.910-912 | 925 | 930 | 960 | 967 | 970 | 980 | 990

OM 502 A | LA

Mercedes-Benz –



Das Original

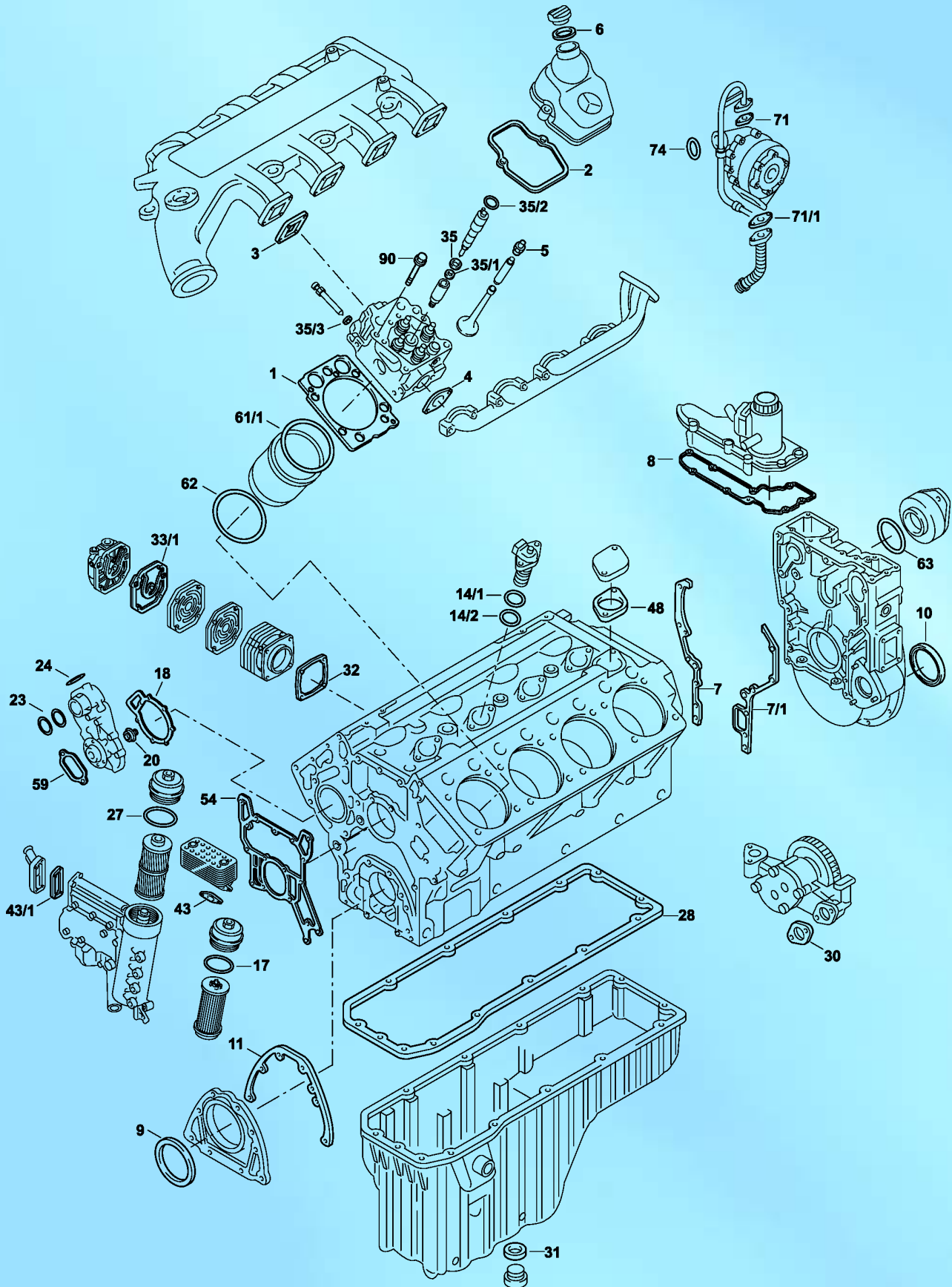



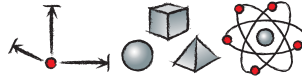

48	207.410	1x	541 201 01 80	-	-
54	052.351	1x	541 184 07 80	-	-
59	a.A.	1x	942 501 00 80	-	-
61/1	162.050	8x	541 011 00 59	Metal 0,15 mm	Tombak
62	641.140	16x	541 011 10 45	150x159,6x4,8 FPM RD	-
63	748.501	1x	005 997 19 45	92x98x3 NBR RD	-
71	756.874	2x	442 187 01 80	-	-> Mot. 064475
71/1	756.866	2x	442 187 00 80	-	-
74	249.220	4x	024 997 16 48	54x8 FPM RD	-
90	a.A.	32x	541 990 05 01	-	-