

MOT. TD 122 F | FA | FH | FK | FL | FR | FS
MOT. TD 123 E | ES

TD 122 | 123

Volvo –



Das Original

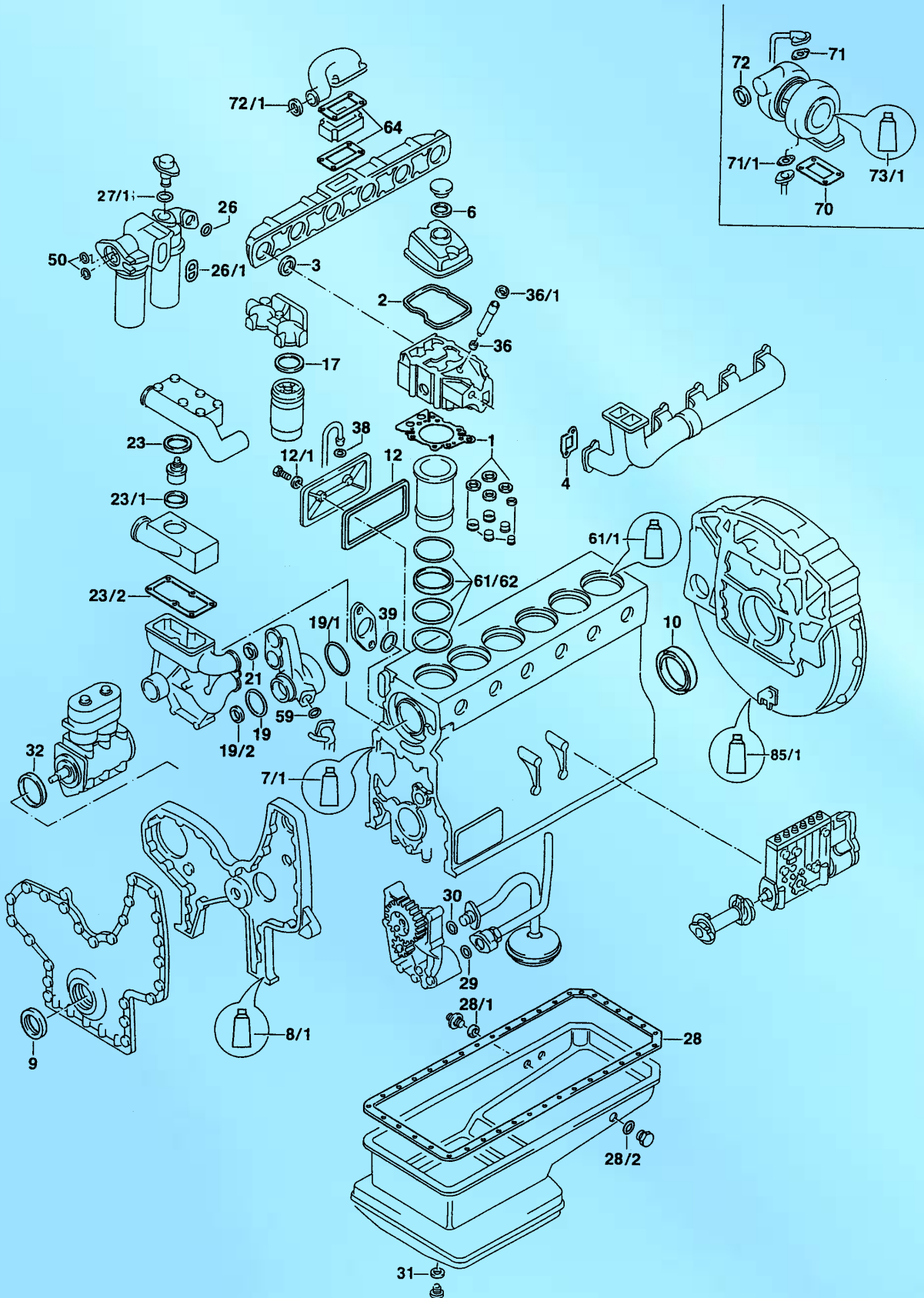

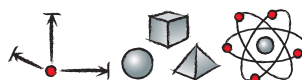

S ⊕ *	917.117	1x	-	-	F 12 ab Chassis 314000 F 12 starting with chassis and higher 314000 F 12 à partir du châssis 314000 F 12 a partir del chasis 314000 F 12 da telaio 314000 F 12 начиная с шасси 314000 N 12 ab Chassis 306000 N 12 starting with chassis and higher 306000 N 12 à partir du châssis 306000 N 12 a partir del chasis 306000 N 12 da telaio 306000 N 12 начиная с шасси 306000 ohne Zylinderlaufbüchsenringe without cylinder liner rings sans bagues de chemise de cylindre sin anillos de camisa del cilindro senza anelli canna без уплотнительных колец
ES ⊕	917.109	1x	-	-	-
CS *	755.648	1x	276 125-2	-	F 12 ab Chassis 314000 F 12 starting with chassis and higher 314000 F 12 à partir du châssis 314000 F 12 a partir del chasis 314000 F 12 da telaio 314000 F 12 начиная с шасси 314000 N 12 ab Chassis 306000 N 12 starting with chassis and higher 306000 N 12 à partir du châssis 306000 N 12 a partir del chasis 306000 N 12 da telaio 306000 N 12 начиная с шасси 306000
CS *	108.325	1x	276 124-5	-	N 12 S
ZLBS	755.672	6x	270 950-9	-	-
AAS	087.352	1x	270 772-7	-	-
ZKHS	087.343	1x	275 554-4	-	-
ZKS	820.369	6x	470 261-9 (8x)	-	-
1	755.621	6x	270 949-1	-	-
2	776.468	6x	424 692-2	-	-
3	088.056	6x	423 174-2	78,5x85,5x4,5 NBR A	-
4	527.319	6x	470 534-9	-	-
6	045.721	1x	940 096-1	42x47x3 NBR A	-
7/1	610.020	1x	1 161 231-4	Dirko grau 310 ml Dirko grey 310 ml Dirko gris 310 ml Dirko grigio 310 ml Dirko серый 310 мл	-
8/1	610.020	1x	1 161 231-4	Dirko grau 310 ml Dirko grey 310 ml Dirko gris 310 ml Dirko grigio 310 ml Dirko серый 310 мл	-
9	570.495	1x	424 983-5	85,7x114,3x13 AW/BS RD FPM	-
10	760.315	1x	469 336-2	155x180x15 AW/BS LD FPM	-
12	101.339	3x	469 823-9	-	-
12/1	a.A.	6x	471 856-5	14,5x20x3 NBR RD	-
17	-	2x	6638 088-2	-	-
19	a.A.	1x	925 257-8	89,5x95,5x3 NBR RD	-
21	a.A.	3x	1 664 473-4	59,5x65,5x3 EPDM RD	-
22	-	-	-	-	-
22/1	-	-	-	-	-
23	a.A.	1x	1 544 410-2	77,5x84x4,6 EPDM PR	-
23/1	754.854	1x	1 544 710-5	57,76x67,55x6,4 PTFE	-
23/2	a.A.	1x	423 352-4	-	-
26	a.A.	1x	949 659-7	34,2x40,2x3 FPM RD	-
26/1	a.A.	1x	469 486-5	FPM PR	-
27/1	a.A.	1x	949 659-7	34,2x40,2x3 FPM RD	-

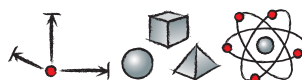

28	477.030	1x	424 603-9	4-teilig 4 pieces 4 pièces 4 piezas in 4 parti из 4-х частей	Blechölwanne stamped oil pan carter d'huile en tôle cárter de aceite de chapa coppa olio in lamiera Масляный поддон штампо ванний
28	749.487	1x	478 505-1	einteilig single-piece mono pièce monopieza in un pezzo unico из одной части	Blechölwanne stamped oil pan carter d'huile en tôle cárter de aceite de chapa coppa olio in lamiera Масляный поддон штампо ванний
28/1	a.A.	1x	949 658-9	24,2x30,2x3 FPM RD	grün green vert verde verde зеленый
28/2	a.A.	1x	468 947-7	-	-
29	-	-	-	-	-
30	a.A.	1x	470 383-1	25,3x33,3x5 FPM A	-
31	129.100	1x	18 677-5	22x29x1,5 CU A DIN 7603	-
32	-	1x	915 610-7	115x121,2x3,1 FPM RD	violett violet violet violeta viola фиолетовый
36/1	a.A.	6x	466 405-8	24x33x5 VMQ A	-
38	a.A.	1x	421 158-7	29x35x5 NBR A	-
39	a.A.	1x	949 657-1	22,2x28,2x3 FPM RD	-
59	a.A.	1x	925 092-9	54,5x60,3x3 NBR RD	-
61	813.451	6x	470 922-6	140,5x145,3x2,4 FPM RD	-
61/1	036.161	1x	1 161 277-7	Dirko grau 70 ml Dirko grey 70 ml Dirko gris 70 ml Dirko grigio 70 ml Dirko серый 70 мл	-
62	-	12x	470 190-0	142,6x154,2x5,8 FPM RD	schwarz black noir negro nero черный
62	813.583	6x	424 833-2	142,6x154,2x5,8 FPM RD	violett violet violet violeta viola фиолетовый
64	a.A.	2x	424 618-7	-	-
70	a.A.	1x	470 939-0	-	-
71	a.A.	1x	420 641-3	-	-
71/1	753.262	1x	420 643-9	-	TD 122 F FH, TD 123 E
71/1	a.A.	1x	470 993-7	-	TD 122 FA FK FR FS FL
72	-	-	-	-	-
73/1	-	-	-	-	-
85/1	610.020	1x	1 161 231-4	Dirko grau 310 ml Dirko grey 310 ml Dirko gris 310 ml Dirko grigio 310 ml Dirko серый 310 мл	-
90	a.A.	48x	470 261-9	-	-